

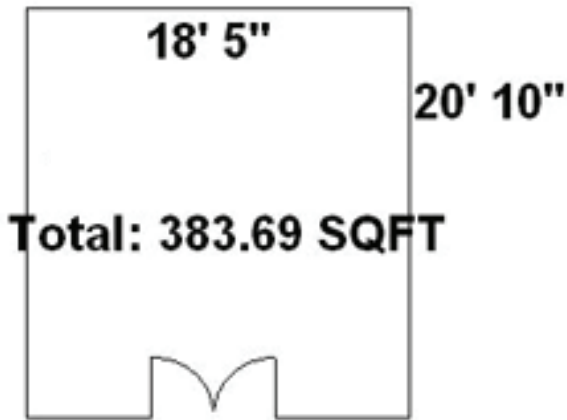

THE HEADLINERS CLUB

THE SHIVERS ROOM



Located on the 21st Floor of the Chase Tower, the Shivers Room provides guests a North Austin view overlooking the Texas State Capitol and the University of Texas Campus.

Capacities and Possible Room Set-ups for the Shivers Room

- 6-8 using 60" round table
- 10-11 using 72" round table
- 12-13 using 96" round table
- 12-18 using rectangular table
- 12-24 using multiple round tables

The above table arrangements are only some of the possibilities and are dependent upon individual set up requests and requirements. Please consult the Catering Department for further information and assistance.